



## Cheldon Avenue

**£825,000**

Located in the highly sought after Lidbury Square development and in excellent condition is this well proportioned 4 bedroom 2 reception room property.

On the ground floor, the property benefits from a bright and spacious through lounge with direct access to a south facing garden, separate dining room and a modern open plan kitchen breakfast room and W/C. The first floor boasts 3 bedrooms and 2 bathrooms ( 1 en-suite). On the second floor there is the master bedroom with fitted wardrobes and an en-suite.

Further benefits include a garage, off-street parking, walking distance to Mill Hill East station and amenities.

Viewing Highly recommended. Sole Agent.

### Viewing

Please contact our Mill Hill Office on 020 8959 0011 if you wish to arrange a viewing appointment for this property or require further information.



4



3



2



C



Floor Plan

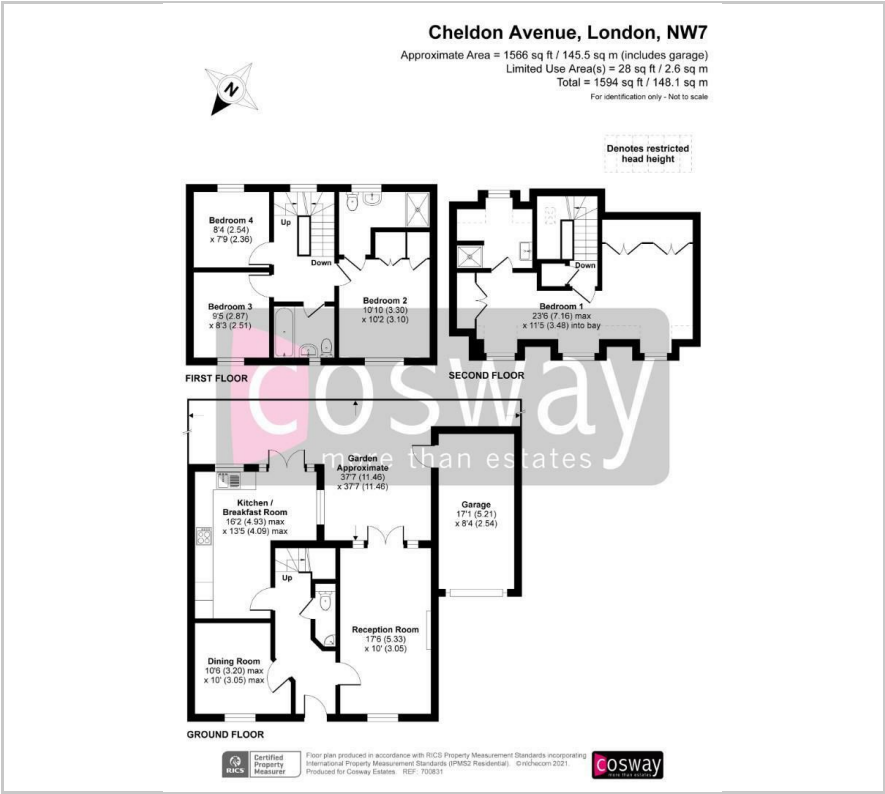

Area Map



Energy Efficiency Graph

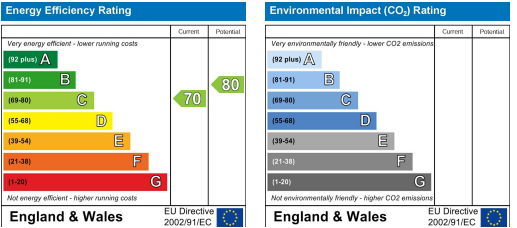

These particulars, whilst believed to be accurate are set out as a general outline only for guidance and do not constitute any part of an offer or contract. Intending purchasers should not rely on them as statements of representation of fact, but must satisfy themselves by inspection or otherwise as to their accuracy. No person in this firm's employment has the authority to make or give any representation or warranty in respect of the property.